

PARTS LIST		CAST STAINLESS STEEL DEWATERING PUMP			10/24/2017	
ITEM	PART No.	DESCRIPTION	QTY	SIZE	MATERIAL	NOTES
1	011-000-07	Shackle	2	6mm	SUS316	
2	095-000-91	Chain	2	d5(9-Link)	SUS316	
3	010-000-37	Cable Clip	2set		SUS316	
4	140-055-36	Hex.Bolt	8	M8x25	SUS316	
5	141-005-21	Hex.Nut	8	M8	SUS316	
6	009-113-17	Terminal	6	R-38-10	CU	included in #18 cable assembly included in #19 cable assembly
7	009-168-17	Terminal	1	R-22-S6	CU	
8	009-116-10	Terminal	3	R-2-4	CU	included in #19 cable assembly
9	010-129-10	Cable Clip Rubber	2	115x100x2t	NBR	
10	140-056-66	Hex.Bolt	8	M8x30	SUS316	included in #18 cable assembly included in #19 cable assembly
11	141-005-21	Hex.Nut	8	M8	SUS316	included in #18 cable assembly included in #19 cable assembly
12	003-000-42	Gland	2	No.5	SCS14	included in #18 cable assembly included in #19 cable assembly
13	004-113-12	Cable Bush	2	No.12	SBR	included in #18 cable assembly included in #19 cable assembly
14	006-000-55	Stuffing Box	2	No.5	SCS14	included in #18 cable assembly included in #19 cable assembly
15	140-076-20	Hex.Bolt	8	M10x30	SUS316	
16	142-164-22	Spring Washer	8	M10	SUS316	
17	122-264-18	O-Ring	2	140xd3.5	NBR	*
18	001-009-30	Cabtyre Cable Set (65') 60Hz(USA)	1	2PNCTF3Cx38mm2	No.5	
19	001-009-31	Cabtyre Cable Set (65') 60Hz(USA)	1	2PNCTFMulti-core7Cx38mm2	No.5	
20	008-105-13	Mould Cover	2	No.3	NBR	included in #18 cable assembly included in #19 cable assembly
21	003-149-14	Gland (Lower)	2	No.5	FC	included in #18 cable assembly included in #19 cable assembly
22	142-162-17	Spring Washer	8	M6	SUS304	included in #18 cable assembly included in #19 cable assembly
23	140-033-12	Hex.Bolt	8	M6x16	SUS304	included in #18 cable assembly included in #19 cable assembly
24	141-004-59	Hex.Nut	6	M6	SWRM	
25	009-108-19	Terminal	6	R-38-6	CU	included in #18 cable assembly included in #19 cable assembly
26	009-108-19	Terminal	6	R-38-6	CU	
27	140-029-28	Hex.Bolt	6	M6x10	SWRM	
28	002-000-18	Heat Shrink Tube (Sold per meter)	m	W3F2(3/4IN)	(/m)	
29	200-000-23	Electical tape (30M)		540S(0.18T-30Wx30M)		
30	143-041-12	Pan Screw	1	M6x8	SWRM	
31	009-168-17	Terminal	1	R-22-S6	CU	included in #19 cable assembly
32	009-114-18	Connector	3	PC-4020M		
33	009-115-19	Connector	3	PC-4020F		included in #19 cable assembly
34	127-001-06	Stay	1	LH890/8110	SUS316	
35	140-125-25	Hex.Bolt	2	M16x45	SUS316	
36	142-166-24	Spring Washer	2	M16	SUS316	
37	142-130-32	Plain Washer	2	M16	SUS316	
38	142-001-04	Washer		0.8/1.2/2.3	SUS316	

PARTS LIST		CAST STAINLESS STEEL DEWATERING PUMP			10/24/2017	
ITEM	PART No.	DESCRIPTION	QTY	SIZE	MATERIAL	NOTES
39	142-165-23	Spring Washer	2	M12	SUS316	
40	140-099-29	Hex.Bolt	2	M12x40	SUS316	
41	140-099-29	Hex.Bolt	10	M12x40	SUS316	
42	142-165-23	Spring Washer	10	M12	SUS316	
43	037-000-89	Flanged Discharge Pipe	1	200mm(GH-370L)	SCS14	
44	121-000-78	Packing	1	LH-90/110 (10Hole)	NAS	* interchangeable with OLD part# 121-145-19
45	140-072-13	Hex.Bolt	3	M10x15	SUS304	
46	142-164-19	Spring Washer	3	M10	SUS304	
47	217-000-23	Fixing Plate	1		SS	
48	016-000-05	Protection Bush	1		NBR	
49	140-033-41	Hex.Bolt	2	M6x16	SUS316	
50	214-000-12	Blind Cover	1	SA1-2-110-LHS	SUS316	
51	121-001-24	Packing	1		NBR	*
52	148-000-01	Grease Nipple	1	A-PT1/4	SUS304	
53	016-000-06	Protection Bush	1		NBR	
54	072-129-38	Eye Bolt	2	M42	SUS316	
55	035-102-14	Air Tightness Test Plug	1	M12x16(B=21)	SUS316	
56	122-259-10	O-Ring	1	12xd3	NBR	*
57	140-001-23	Hex.Bolt	8	M16x105	SUS316	
58	142-166-24	Spring Washer	8	M16	SUS316	
59	142-001-05	Plain Washer	8	d16.5xd33.5x5t	SUS316	
60	121-001-25	Seal Packing	8	d16xd26x4t	NBR	*
61	050-001-33	Motor Bracket	1	SA1-2-110-LHS	SCS14	
62	146-034-11	Retaining Ring	1	C60	SK5	
63	052-148-15	Bearing	1	NU-312A		
64	026-273-19	Oil Seal	1	SC-8010513	NBR	
65	113-000-06	Upper Bearing Grease Pan	1		FC	
66	142-163-34	Spring Washer	4	M8	SWRH	
67	140-055-49	Hex.Bolt	4	M8x25	SWRM	
68	122-000-22	O-Ring	1	V-530(524.5xd10)	NBR	*
69	065-000-69	Outer Cover	1	SA1-2-110-LHS	SUS316	
70	122-000-22	O-Ring	1	V-530(524.5xd10)	NBR	*
71	055-003-30	Rotor	1Set	SA1-2-110-LHS		
72	147-000-70	Impeller Key	1	12x8x56	SUS316	
73	053-306-16	Motor Protector	3	9700K-06-215	(H)	
74	056-009-41	Stator 460V-60Hz(USA)	1Set			
	056-009-42	Stator 575V-60Hz(USA)	1Set			
75	122-000-46	O-Ring	1	AN384(391.05xd5.34)	NBR	*

PARTS LIST		CAST STAINLESS STEEL DEWATERING PUMP			10/24/2017	
ITEM	PART No.	DESCRIPTION	QTY	SIZE	MATERIAL	NOTES
76	140-001-24	Hex.Bolt	8	M16x80	SUS316	
77	142-166-24	Spring Washer	8	M16	SUS316	
78	122-000-46	O-Ring	1	AN384(391.05xd5.34)	NBR	*
79	121-001-26	Packing	1	6x6.5x254L		*
80	062-000-17	Bearing Cover	1		FC	
81	140-076-33	Hex.Bolt	4	M10x30	SWRM	
82	142-164-35	Spring Washer	4	M10	SWRH	
83	061-000-06	Bearing Collar	1		SS	
84	052-000-60	Bearing	1Set	7313ADB		
85	141-078-25	Bearing Nut	1	AN13	SUS304	
86	142-246-29	Bearing Washer	1	AW13	SUS304	
87	060-001-96	Bearing Housing	1	SA1-2-110-LHS	SCS14	
88	122-259-10	O-Ring	1	12xd3	NBR	*
89	035-102-14	Oil Plug	1	M12x16(B=21)	SUS316	
90	122-259-10	O-Ring	2	12xd3	NBR	*
91	035-102-14	Oil Plug	2	M12x16(B=21)	SUS316	
92	122-016-13	O-Ring	8	P-16(15.8xd2.4)	NBR	*
93	144-000-91	Stud Bolt	8	M16x80(28/20)	SUS316	
94	090-122-11	Leakage Sensor(Electrode)/w Gland	1Set	d9x43L	SUS	
95	142-161-32	Spring Washer	2	M5	SWRH	
96	140-021-33	Hex.Bolt	2	M5x20	SWRM	
97	026-274-10	Oil Seal	1	SC-507212	NBR	
98	071-000-43	Spacer	3		SS	
99	122-000-47	O-Ring	1	AN372(232.3xd5.34)	NBR	*
100	113-000-07	Lower Bearing Grease Pan	1		FC	
101	142-164-35	Spring Washer	4	M10	SWRH	
102	140-076-33	Hex.Bolt	4	M10x30	SWRM	
103	025-000-65	Mechanical Seal	1	H-50TX(E)	SIC	
104	143-028-13	Pan Screw	3	M5x10	SWRM	
105	030-133-19	Oil Lifter	1	H-50(T)	SPCC	
106	122-270-17	O-Ring	1	350xd5.7	NBR	*
107	029-001-15	Oil Casing	1	GH-1100	SCS14	
108	122-270-17	O-Ring	1	350xd5.7	NBR	*
109	142-165-23	Spring Washer	8	M12	SUS316	
110	140-097-27	Hex.Bolt	8	M12x30	SUS316	
111	071-000-62	Shaft Sleeve (Upper)	1	GH-550/750	SUS316	
112	071-000-63	Shaft Sleeve (Lower)	1	d45xd49x57.5L	SUS316	
113	122-271-18	O-Ring	1	540xd5.7	NBR	*

PARTS LIST		CAST STAINLESS STEEL DEWATERING PUMP			10/24/2017	
ITEM	PART No.	DESCRIPTION	QTY	SIZE	MATERIAL	NOTES
114	020-003-41	Pump Casing (Upper)(60Hz) (w/Labyrinth Ring)	1	LH890/8110-60	SCS14	
115	144-000-92	Stud Bolt	8	M16x72(28/32)	SUS316	
116	142-166-24	Spring Washer	8	M16	SUS316	
117	141-008-24	Hex.Nut	8	M16	SUS316	
118	040-000-14	Impeller Shim		d45.2xd68x0.3t	SUS316	
119	021-010-03	Impeller (60Hz)	1	LH8110-69	SCS14	
120		Impeller Fixing Washer	1	d33xd75x8t	SUS316	
121	141-000-26	Hex.Nut	1	M30(H=18)	SUS316	
122	141-000-27	Hex.Cap Nut	1	M30	SUS316	
123	020-003-34	Pump Casing (Lower)(60Hz) (w/Labyrinth Ring)	1	LH8110-69	SCS14	
124	142-166-24	Spring Washer	8	M16	SUS316	
125	141-008-24	Hex.Nut	8	M16	SUS316	
126	140-103-27	Hex.Bolt	4	M12x60	SUS316	
127	144-000-93	Stud Bolt	4	M16x110(24/24)	SUS316	
128	122-302-19	O-Ring	1	215xd3.8	NBR	*
129	120-118-10	Packing (S.Cover)		d211xd274x0.5t	PE	
130	034-000-71	Suction Mouth(60Hz)	1	GH-890	SCS14	
131	142-165-23	Spring Washer	6	M12	SUS316	
132	140-098-28	Hex.Bolt(60Hz)	6	M12x35	SUS316	
133	141-007-23	Hex.Nut	3	M12	SUS316	
134	142-165-23	Spring Washer	3	M12	SUS316	
135	142-129-38	Plain Washer	3	M12	SUS316	
136	043-102-19	Cathodic Protection Plate	3	AB-1HS(75x70x20t)	Al	
137	023-001-91	Strainer Stand	1	LH890/8110	SUS316	
138	140-097-27	Hex.Bolt	3	M12x30	SUS316	
139	141-008-24	Hex.Nut	4	M16	SUS316	
		<NPT Flange Version>				
	048-000-79	Screwed Flange	1	NPT-8(JIS10K)	SCS14	
	121-109-24	Packing	1	JIS10Kx200mm	NR	
	140-001-26	Hex.Bolt	12	M20x85	SUS316	
	142-168-42	Spring Washer	12	M20	SUS316	
	141-009-41	Hex.Nut	12	M20	SUS316	
	173-002-56	<b>Packing O-Ring Set</b>	1Set	(Marked by *)		
17	122-264-18	O-Ring (S.Box)	2	140xd3.5	NBR	*
44	121-145-19	Packing (Discharge Pipe)	1	GH-370	NBR	*
51	121-001-24	Packing (Blind Cover)	1		NBR	*
56	122-259-10	O-Ring (Air Tightness Test Plug)	1	12xd3	NBR	*
60	121-001-25	Seal Packing (M.Bracket Bolt)	8	d16xd26x4t	NBR	*

PARTS LIST		CAST STAINLESS STEEL DEWATERING PUMP				10/24/2017
ITEM	PART No.	DESCRIPTION	QTY	SIZE	MATERIAL	NOTES
68	122-000-22	O-Ring (M.Bracket/Out.Cover)	1	V-530(524.5xd10)	NBR	*
70	122-000-22	O-Ring (Out.Cover/M.Frame)	1	V-530(524.5xd10)	NBR	*
75	122-000-46	O-Ring (M.Bracket/M.Frame)	1	AN384(391.05xd5.34)	NBR	*
78	122-000-46	O-Ring (M.Frame/Brg.Housing)	1	AN384(391.05xd5.34)	NBR	*
79	121-001-26	Packing (Bearing Collar)	1	6x6.5x254L		*
88	122-259-10	O-Ring (Oil Plug)	1	12xd3	NBR	*
90	122-259-10	O-Ring (Oil Plug)	2	12xd3	NBR	*
92	122-016-13	O-Ring (Upp. P.Casing Bolt)	8	P-16(15.8xd2.4)	NBR	*
99	122-000-47	O-Ring (Brg.Housing/Grease Pan)	1	AN372(232.3xd5.34)	NBR	*
106	122-270-17	O-Ring (Brg.Housing/O.Casing)	1	350xd5.7	NBR	*
108	122-270-17	O-Ring (O.Casing/Upp. P.Casing)	1	350xd5.7	NBR	*
113	122-271-18	O-Ring (Brg.Housing/Upp. P.Casing)	1	540xd5.7	NBR	*
128	122-302-19	O-Ring (Mouth Ring/Low. P.Casing)	1	215xd3.8	NBR	*
		Lubricant		Turbine Oil VG32 7,100ml		

PARTS LIST		CAST STAINLESS STEEL DEWATERING PUMP				10/24/2017
ITEM	PART No.	DESCRIPTION	QTY	SIZE	MATERIAL	NOTES

J4-43940-1

## EXPLODED VIEW

LH6110/8110-14-69

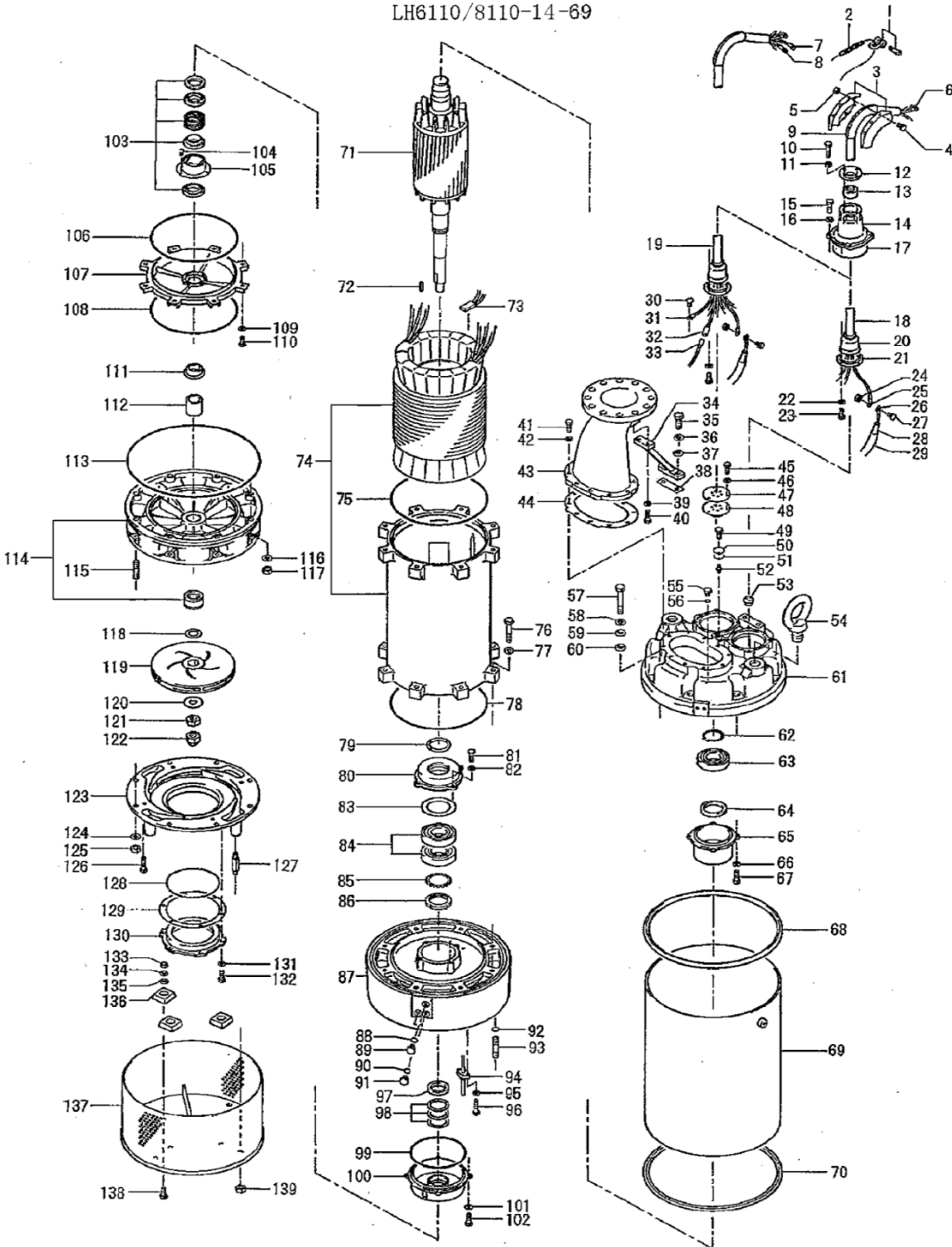

\* Indicates items included in set